



PROTON
INSPIRING CONNECTIONS

PERSONA

QUICK GUIDE

A Member of

DRB-HICOM

This quick guide is not intended to replace the Owner's Manual. Owner should always refer to the Owner's Manual for clear understanding to avoid any complication during the vehicle's operations, and to read all precautions and notes as highlighted in the Owner's Manual.

Remote transmitter

To use the key

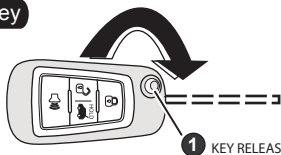

Press **1** to release and fold the key in place

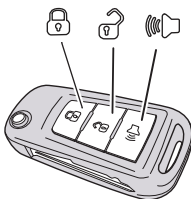

Type A

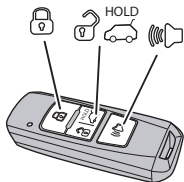

Type B

Features		Type A	Type B
Locking		✓	✓
Unlocking		✓	✓
Panic		✓	✓
Trunk lid remote release		Not applicable	✓
Keyless entry		Not applicable	✓

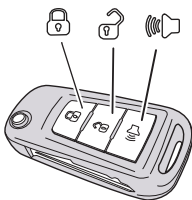

Type A

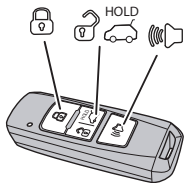

Type B

Remote keyless entry system

Central lock / unlock



Press  to unlock all doors.

Press  to lock all doors.

Panic alarm



Press  to activate panic alarm.

Trunk lid remote release (for some types)

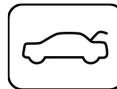

Press  ^{HOLD} for more than 3 seconds to unlock the trunk lid.

Vehicle search



While the vehicle is in arm mode, press  twice. The turn signal lights will flash three times to indicate the location of the vehicle.

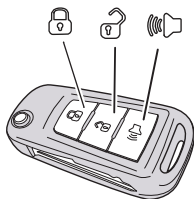

Type A

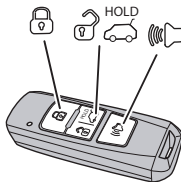

Type B



Auto re-locking

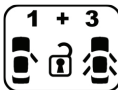

When you press , the system will unlock all doors. If you do not open any doors, hood or trunk lid within 30 seconds, the system will re-lock all doors automatically.

Double Stage Unlocking





To change from central unlock mode to double stage unlock mode, press  and  simultaneously until the turn signal lights flash twice.

In Double Stage Unlock mode

When you press , only the driver's door is unlock.

When you press  again, the other three doors will unlock.

To change from double stage unlock mode to central unlock mode, press  and  simultaneously until the turn signal lights flash twice.

Door operation and usage

To open the door from inside

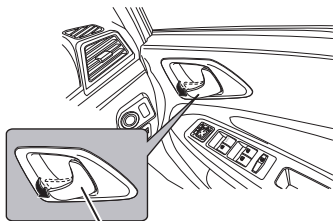

Inside handle

To open the door, pull the inside handle towards you.

In central lock mode

Pull the inside handle towards you twice;

1st pull - all doors is unlock
2nd pull - the door will open

To open the door from outside

In case of emergency

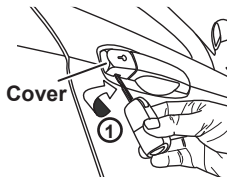

1 - Insert the key into the slot of the cover and twist. The cover will slightly open.

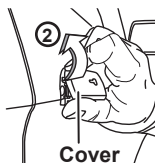

2 - Open the cover

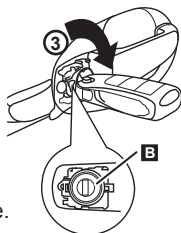

3 - To unlock, insert the key. Then, turn the key clockwise.

USB interface and power socket

- 1 - USB charging slot
- 2 - USB charging slot
- 3 - USB data slot
- 4 - Power socket (12 V)
- 5 - USB charging slots

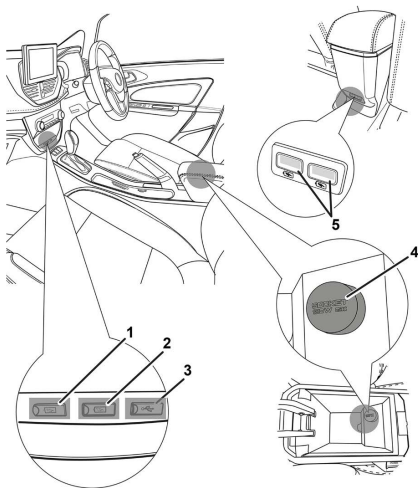

The USB interface and power socket are located at the lower center panel. This connection can be used to plug in USB. The ignition switch must be in “ACC” or “ON” position.

Start stop button (for some types)

Important information

This vehicle has a gear shift lock for additional anti-theft security. Follow the instructions for maximum security.

To START the engine

While the ignition is OFF;

Start the Engine

1

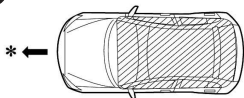

Make sure the remote transmitter is inside the cabin area.

* : Forward direction

▨ : Operating range
(to start or turn off the engine)

2

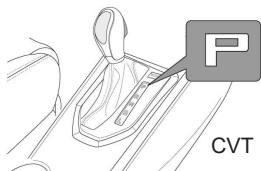

CVT model :
The shift lever in P position

3

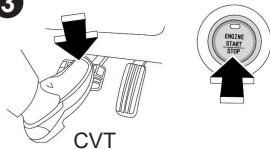

CVT model :
While you press the brake pedal,
press the start stop button.

To TURN OFF the engine

While the engine is running;

- 1 CVT model : Put the shift lever in P position

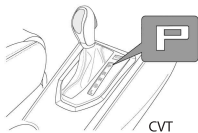

- 2 Press the start stop button.

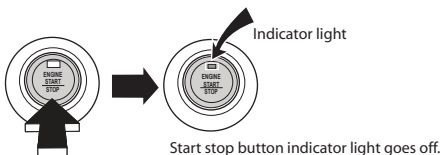

Make sure the indicator light is OFF.

This condition indicates that the whole vehicle system is completely OFF.

Keyless Entry System (for some types)

Operating range

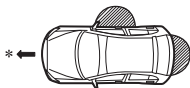

* : Forward direction

▨ : Operating range

Open the doors / trunk lid via Keyless Entry System

Operating range :

- 1.2 ~ 1.5 metres from driver's door handle
- 1 metre from trunk lid switch

Remote transmitter

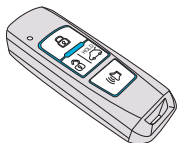

Make sure you carry the remote transmitter with you to operate the keyless entry system.

Type B

To open the door via keyless entry

While the doors are locked;

- 1) Make sure the remote transmitter is within the operating range.
- 2) Press the keyless entry switch on the outer door handle of driver door within the operating range and open the door.

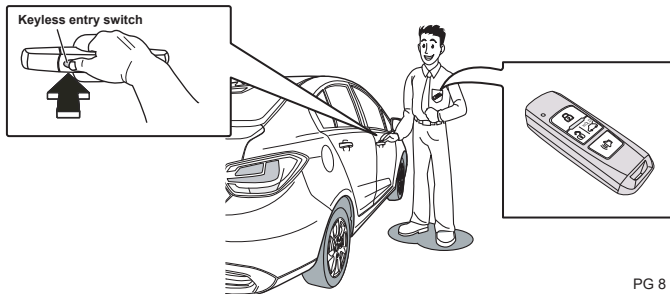

To open the trunk lid via keyless entry

While the doors are locked;

- 1) Make sure the remote transmitter is within the operating range.
- 2) Press the keyless entry switch under the rear garnish.

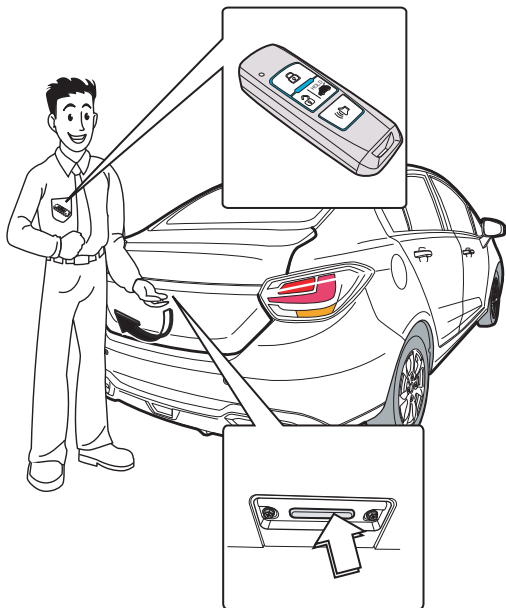

Note

For other features which are not stated in this quick guide, please refer to the complete owner's manual for details.

Tyre Pressure

Cold tyre inflation pressure

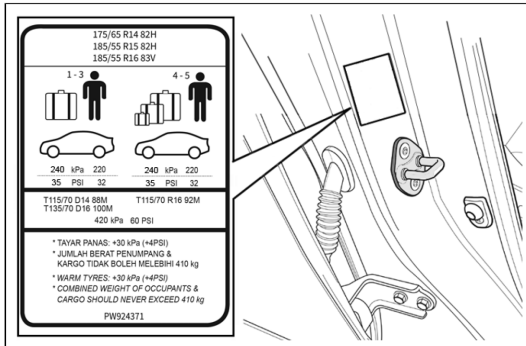

There is label that shows the recommended cold tyre pressure at your doorjamb.

Check the pressure of all tyres when these tyres are cold.

NOTE

The tyre pressure value shown at the picture might be different from your vehicle requirement. In this case, the actual label on your vehicle will prevail.

Tyres are cold when the vehicle is parked at minimum three hours or driven less than a kilometre.

After adjusting the tyre inflation pressure, check the tyres for any damage and air leaks.

Make sure again the rubber caps are reinstalled on the valves.

**VERSI
BAHASA MELAYU**

Buku panduan ringkas ini diadakan bukan untuk menggantikan buku panduan yang utama.

Pemilik perlu sentiasa merujuk kepada buku panduan utama untuk mendapatkan pemahaman yang lebih jelas bagi mengelakkan sebarang masalah ketika mengendalikan kenderaan ini dan membaca semua amaran dan peringatan yang tertera di dalam buku panduan utama.

Alat kawalan jauh

Cara penggunaan

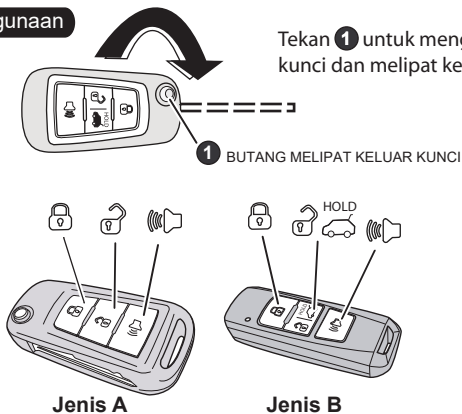

Ciri-ciri		Jenis A	Jenis B
Mengunci		✓	✓
Membuka Kunci		✓	✓
Amaran panik		✓	✓
Membuka penutup bonet belakang menggunakan alat kawalan jauh	HOLD 	Tidak dilengkapi	✓
Akses tanpa menggunakan suis alat kawalan jauh atau kunci		Tidak dilengkapi	✓

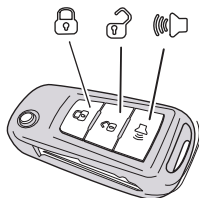

Jenis A

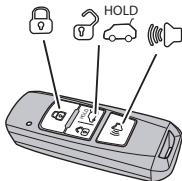



Jenis B

Sistem alat kawalan jauh

Kunci / membuka kunci secara berpusat



Tekan  untuk membuka kunci semua pintu.
Tekan  untuk mengunci semua pintu.

Amaran panik



Tekan  untuk mengaktifkan amaran panik.

Membuka bonet belakang (untuk sebahagian model)

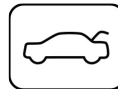

Tekan  lebih daripada 3 saat untuk membuka penutup bonet belakang.

Pencarian kenderaan



Ketika sistem penggera kenderaan ini sedang aktif, tekan . Lampu isyarat belok akan berkelip sebanyak kali untuk menunjukkan lokasi kenderaan ini.

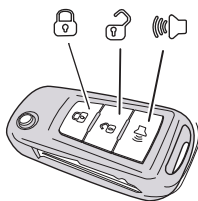

Jenis A

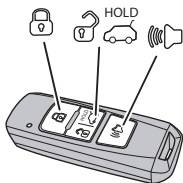

Jenis B



Penguncian semula

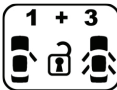

Apabila anda menekan , semua pintu akan dibuka kunci. Jika tiada pintu, bonet hadapan atau bonet belakang dibuka dalam masa 30 saat, semua pintu akan dikunci semula secara automatik.

Membuka kunci secara dua peringat





Untuk menukar daripada mod membuka kunci secara berpusat kepada mod membuka kunci secara dua peringat, tekan  dan  dengan serentak sehingga lampu isyarat belok berkelip sebanyak dua kali.

Dalam mod membuka kunci secara dua peringat

Apabila anda menekan , hanya pintu pemandu akan dibuka kunci.

Apabila anda menekan  semula, ketiga-tiga pintu lain akan dibuka kunci.

Untuk menukar daripada mod membuka kunci secara dua peringat kepada mod membuka kunci secara berpusat, tekan  dan  dengan serentak sehingga lampu isyarat belok berkelip sebanyak dua kali.

Pengendalian dan penggunaan pintu

Membuka pintu daripada bahagian dalam

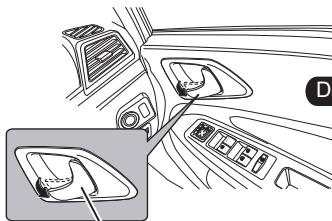

Tuil pada bahagian dalam pintu

Tarik tuil pada bahagian dalam pintu ke arah dalam. Pintu akan dibuka.

Dalam mod kunci pintu secara berpusat

Tarik tuil pada bahagian dalam pintu ke arah dalam sebanyak dua kali; Tarikan pertama - Semua pintu akan dibuka kunci
Tarikan kedua - Pintu pemandu akan dibuka

Membuka pintu daripada bahagian luar

Sewaktu kecemasan

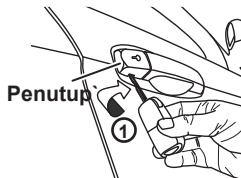

Penutup

1 - Masukkan kunci ke dalam slot penutup dan pusing. Penutup akan terbuka sedikit.

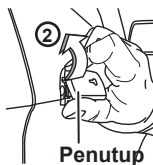

Penutup

2 - Buka penutup.

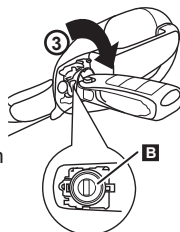

B

3 - Untuk membuka kunci, masukkan kunci. Kemudian, putarkan kunci mengikut arah lawan jam.

USB dan soket kuasa

- 1 – Slot pengecasan USB
- 2 – Slot pengecasan USB
- 3 – Slot data USB
- 4 – Soket Kuasa (12 V)
- 5 – Slot-slot pengecasan USB

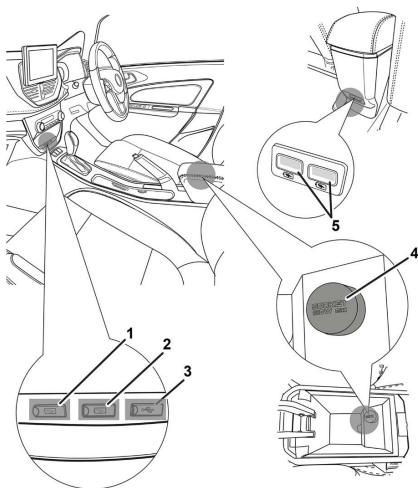

Soket USB dan soket kuasa terletak di bahagian tengah konsol hadapan. Sambungan ini boleh digunakan untuk memasang USB. Suis pencucuh enjin mestilah berada pada kedudukan "ACC" atau "ON".

Butang start stop (untuk sebahagian model)

Maklumat penting

Kenderaan ini dilengkapi dengan kunci tuil penukar gear sebagai fungsi anti-kecurian tambahan. Ikuti arahan-arahan berikut bagi memastikan kenderaan ini mendapat perlindungan sepenuhnya.

Cara menghidupkan enjin

Ketika suis penghidup enjin pada posisi OFF;

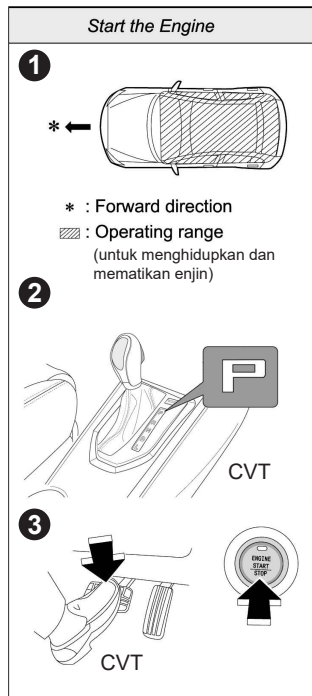

Pastikan alat kawalan jauh berada di dalam ruang kabin penumpang.

Model CVT :
Tuil penukar gear pada posisi P

Model CVT :
Sambil menekan injak brek,
tekan butang start stop.

Cara mematikan enjin

Ketika enjin masih hidup;

- 1** Model CVT : Letakkan tuil penukar gear pada posisi P.

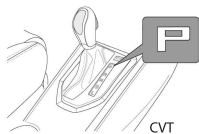

- 2** Tekan butang start stop.



Pastikan lampu penunjuk butang start stop dipadamkan. Keadaan ini menunjukkan keseluruhan sistem kenderaan telah dimatikan sepenuhnya.

Sistem akses tanpa menggunakan suis alat kawalan jauh atau kunci (untuk sebahagian model)

Lingkungan kawasan operasi

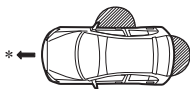

* Arah hadapan kenderaan

▨ Lingkungan kawasan operasi

Membuka pintu / bonet belakang

Lingkungan operasi :

- 1.2 ~ 1.5 meter daripada pemegang pintu luaran bahagian pemandu
- 1 meter daripada suis bonet belakang

Alat kawalan jauh

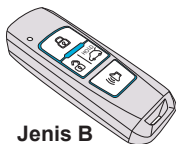

Jenis B

Pastikan anda bawa alat kawalan jauh bersama untuk mengendalikan sistem akses jenis ini.

Membuka pintu dengan cara sistem akses ini

Apabila pintu dalam keadaan terkunci;

- 1) Pastikan alat kawalan jauh berada dalam lingkungan kawasan operasi.
- 2) Tekan suis keyless entry pada pemegang luar pintu pemandu dalam lingkungan kawasan operasi dan buka pintu.

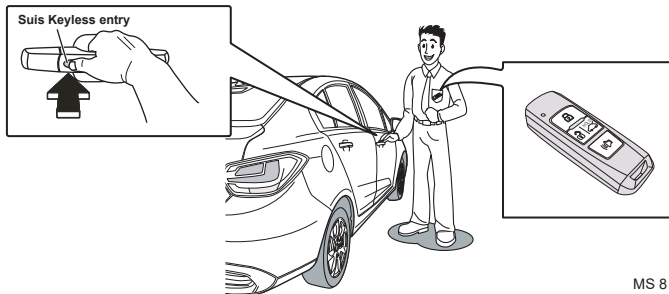

Membuka bonet belakang

Ketika pintu dalam keadaan terkunci;

- 1) Pastikan alat kawalan jauh berada dalam lingkungan kawasan operasi.
- 2) Tekan suis keyless entry di bawah bahagian hiasan penutup bonet belakang.

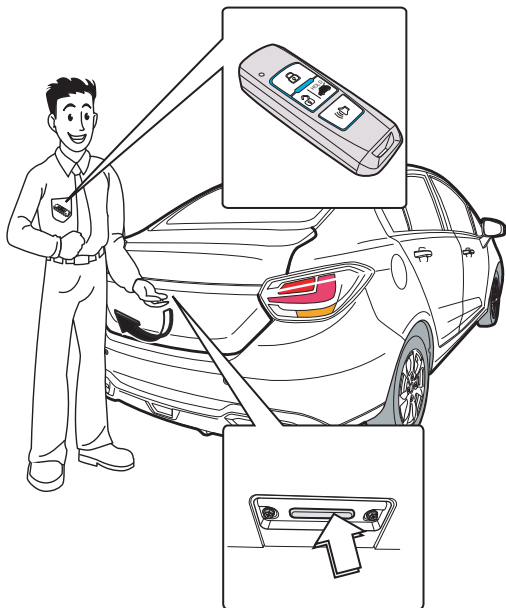

Perhatian

Untuk maklumat bagi fungsi-fungsi lain yang tidak dinyatakan di dalam buku panduan ringkas ini, sila rujuk pada buku panduan utama untuk maklumat terperinci.

Tekanan Angin Tayar

Tekanan angin tayar sejuk

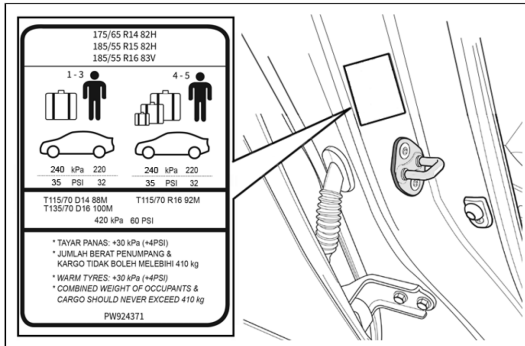

Label tekanan angin terletak di bahagian pintu kenderaan.

Periksa tekanan angin dalam keadaan tayar sejuk.

PERHATIAN

Nilai tekanan tayar yang ditunjukkan pada gambar mungkin berbeza daripada keperluan kenderaan anda. Dalam kes ini, label sebenar pada kenderaan anda akan diutamakan.

Keadaan tayar akan sejuk sekiranya diletakkan paling minimum 3 jam atau digerakkan kurang dari 1 kilometer.

Setelah menyelaraskan tekanan angin tayar, periksa tayar sekiranya terdapat kerosakan dan kebocoran angin.

Pastikan penutup tekanan angin tayar diketatkan semula selepas memasukkan angin.



PERUSAHAAN OTOMOBIL NASIONAL SDN. BHD. (100995-U)

HICOM Industrial Estate, Batu 3,
P.O Box 7100, 40918 Shah Alam,
Selangor Darul Ehsan, Malaysia.
Fax: +603 5191 1252

proton.com

PROTON Customer Care 1 800 888 398